

PC24(WT22) Air Pressure Sensor



- Piezoresistive silicon chip employed
- Without temperature compensation

PC24(WT22) pressure sensor is suitable for dry and non-corrosive air measuring. It is easy for mounting with PCB. It is a solution for low cost application with low requirements.

[Medical application](#)

- Hospital and portable ventilator
- Oxygen concentrators and O₂ Therapy
- Sleep apnea
- Operating room

[Industrial application](#)

- Environmental
- Technology
- Manufacturing

[HVAC application](#)

Heating Ventilating and Air Conditioning

Pressure range	
Pressure range	100Pa, 1kPa, 2kPa, 7kPa, 10kPa (bar and psi unit available)
Pressure reference	Gauge pressure Absolute pressure Differential pressure
Overpressure	300%F.S.
Output signal	
Output	$\geq 30\text{mV}$
Specification	
Accuracy (linearity, repeatability and hysteresis)	$\pm 0.25\% \text{F.S. } (\geq 10\text{kPa})$ $\pm 1.5\% \text{F.S. } (\leq 2\text{kPa})$ $\pm 1\% \text{F.S. } (2\text{kPa}-10\text{kPa})$
Excitation	1.5mA 5VDC
Compensated temp.	Without temperature compensation
Operating temp.	0°C -50°C
Storage temp.	0°C -85°C
Input impedance	2k Ω -5k Ω
Long term stability	$\leq 0.2\% \text{F.S.S./year}$
Housing material	Plastic
Weight	5g(approx)

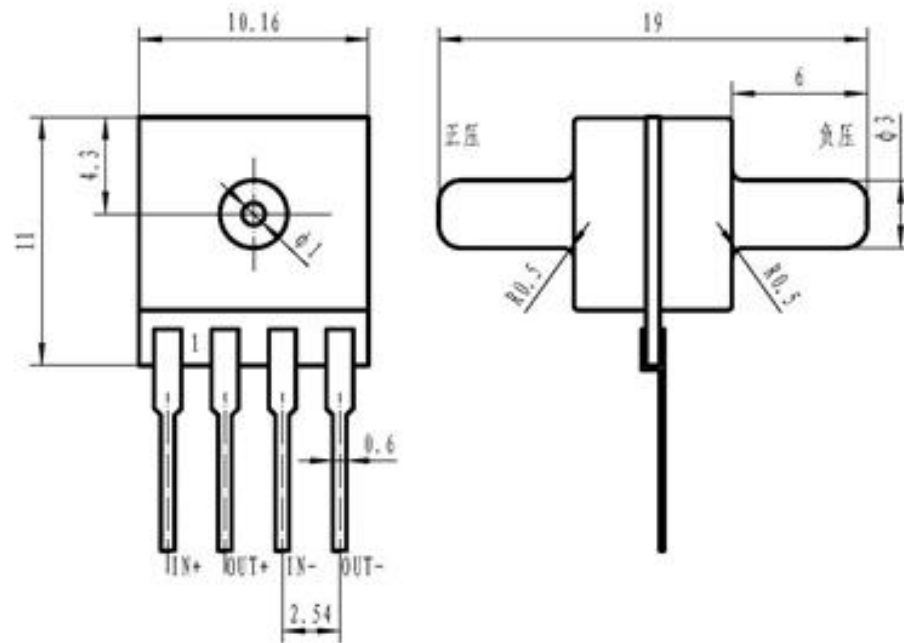

In mm

How to order

PC24 XX XX XX

Pressure range

Please write directly

Pressure reference

G: gauge pressure

A: absolute pressure

D: differential pressure

Excitation

I1: 1.5mA

U4: 5VDC

Wotian reserves the right to make any change in this publication without notice. The information provided is believed to be accurate and reliable as of this product sheet.

Contact us

Nanjing Wotian Technology Co.,Ltd.

website: www.wtsensor.com

Add: 5 Wenying Road, Binjiang Development Zone, Nanjing, 211161, China

Sales Manager: Wuzhou Lian

Email: lianwuzhou@wtsensorus.com