

PCL-V Vortex Flow Meter

Features

- Simple in structure, no motion worn parts
- High measurement accuracy, high reliability, field debugging is not required
- Can transmit traffic signal far away, and can network with computer to realize centralized management
- Magnifying plate adopts unique design, gas and liquid universal measurement

Applications

- widely used in petroleum, chemical, metallurgy, heat, textile, paper and other industries for steam, saturated steam, compressed air and general gas (oxygen, nitrogen hydrogen, natural gas, gas, etc.), water and liquid (such as: water, gasoline, alcohol, benzene, etc.) measurement and control

Notes:

- 1 Do not misuse documentation.
- 2 The information presented in this product sheet is for reference only. Do not use this document as a product installation guide.
- 3 Complete installation, operation, and maintenance information is provided in the instructions of the product.
- 4 Misuse of the product may cause danger or personal injury.



Product overview

Vortex flow meter is widely used in petroleum, chemical, metallurgy, heat, textile, paper and other industries for steam, saturated steam, compressed air and general gas (oxygen, nitrogen hydrogen, natural gas, gas, etc.), water and liquid (such as: water, gasoline, alcohol, benzene, etc.) measurement and control.

Technical indicators	
Nominal diameter (mm)	25, 40, 50, 65, 80, 100, 125, 150, 200, 250, 300 (300~1000 plug-in)
Nominal pressure (MPa)	1.6 (>1.6agreement supply)
Medium temperature (°C)	-40~350 °C
Body material	304SS (other material agreement supply)
Allow vibration acceleration	Piezoelectric: 0.2g capacitive: 1.0~2.0g
Accuracy	±1%r, ±1.5%r, ±1fs; plug-in type: ±2.5%r, ±2.5%fs
Extent	1:6~1:30
Supply voltage	Sensor: +12v dc, +24v dc; transmitter: +12v dc, +24v dc; battery-powered type: 3.6v battery
Output signal	Square wave pulse (excluding battery-powered type): High level ≥5v, low level ≤1v; current: 4~20ma
Pressure loss coefficient	Comply with jb/t9249 standard $cd \leq 2.4$
Explosion-proof mark	Ex ia II CT6 Ga
Protection class	IP65
Environmental conditions	Temperature -20°C~55°C, relative humidity 5%~90%, atmospheric pressure 86~106kpa
Applicable medium	Gas, liquid, steam
Transmission distance	Three-wire pulse output type: ≤300m, two-wire standard current output type (4~20ma): Load resistance ≤750Ω

Flange connection type vortex flow meter size

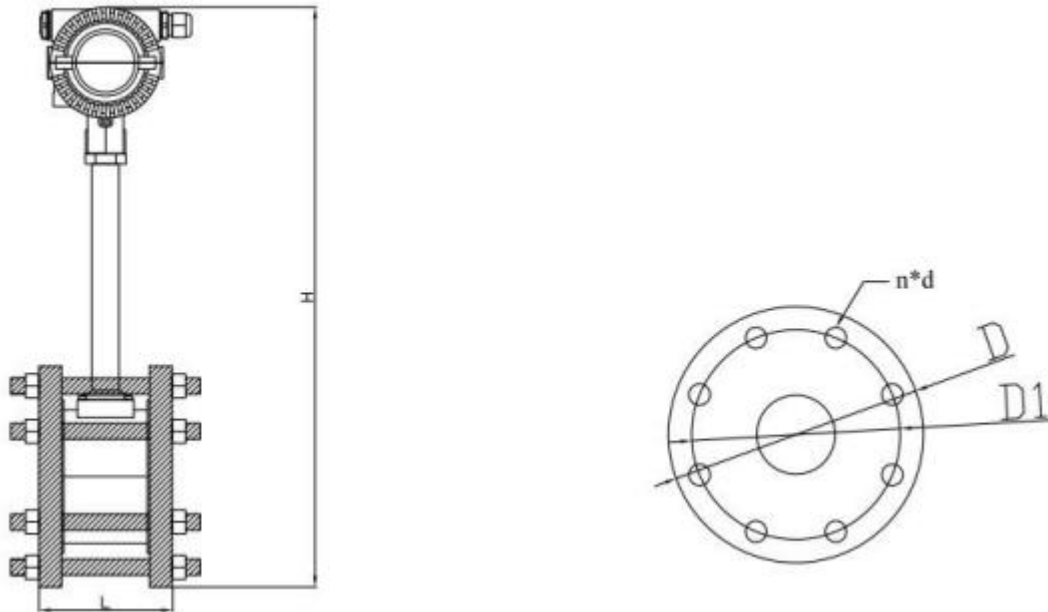

Size (mm)	15	20	25	32	40	50	65	80	100	125	150	200	250	300
L (mm)	95	95	95	114	114	117	117	117	136	151	170	190	205	220
H (mm)	460	460	460	480	490	500	515	530	550	570	600	650	710	760
D (mm)	125	125	125	145	145	160	180	195	215	245	280	335	405	460
DI (mm)	100	100	100	120	120	125	145	160	180	210	240	295	355	410
N (mm)	4	4	4	4	4	4	4	8	8	8	8	12	12	12
D (mm)	14	14	14	14	14	18	18	18	18	18	22	22	26	26

Temperature pressure compensation dimensions

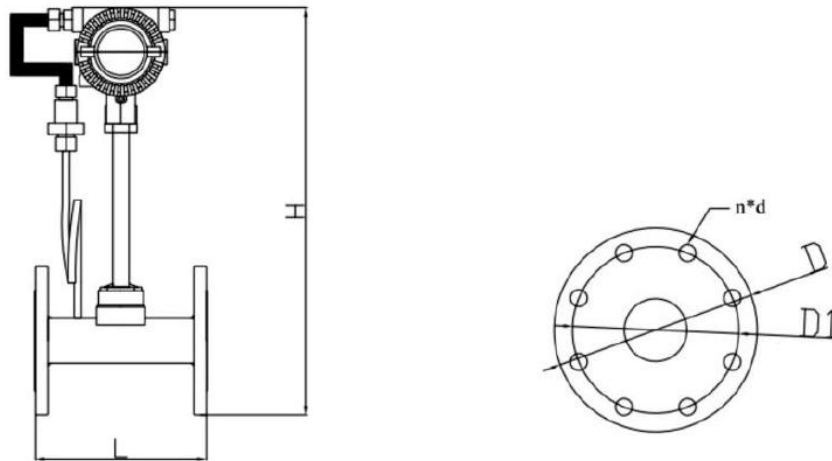

Size (mm)	15	20	25	32	40	50	65	80	100	125	150	200	250	300
L (mm)	180	180	180	180	180	180	200	200	200	220	220	220	250	300
H (mm)	416	423	431	448	456	470	488	501	552	552	584	636	696	749
D (mm)	95	105	115	140	150	165	185	200	220	250	285	340	405	460
DI (mm)	65	75	85	100	110	125	145	160	180	210	240	295	355	410
N (mm)	4	4	4	4	4	4	8	8	8	8	8	12	12	12
d (mm)	14	14	14	18	18	18	18	18	18	18	22	22	26	26

Note: The flange standard of this table is HGT20592 PN16, other flange standards can be customized, please consult before ordering.

Flow Range Table

Gauge diameter (mm)	liquid		Gas	
	Measuring range (m ³ /h)	Output frequency range (Hz)	Measuring range (m ³ /h)	Output frequency range (Hz)
15	0.3~6	30~585	2.8~15	275~1460
20	1~10	40~396	5.5~50	218~1982
25	16~16	32~325	8.5~70	172~1420
32	2~20	21~205	18~130	185~1340
40	2.5~25	13~130	22~220	115~1147
50	3.5~35	9~93	36~320	96~851
65	6.5~68	8~82	50~480	61~583
80	10~100	6~65	70~640	45~417
100	15~150	5~50	130~1100	43~367
125	27~275	5~47	200~1700	33~290
150	40~400	4~40	280~2240	27~221
200	80~800	3~33	580~4960	24~207
250	120~1200	3~26	970~8000	20~171
300	180~1800	2~22	1380~11000	17~136
(400)	180~3000	5.6~87	2750~27000	85~880
(500)	300~4500	5.7~88	4300~43000	85~880
(600)	450~6500	5.7~89	6100~61000	85~880
(800)	750~10000	5.7~88	11000~110000	85~880
(1000)	1200~1700	5.7~88	17000~170000	85~880

Note: 300~1000 diameter is plug-in

Please note the unit in the table, operating flow unit(m³/h, kg/h, t/h), standard flow unit: Nm/h

Operating flow=standard flow unit/(pressure in kilogram +1)

Mass flow rate=volume flow*density

PCL-V Vortex Flow Meter

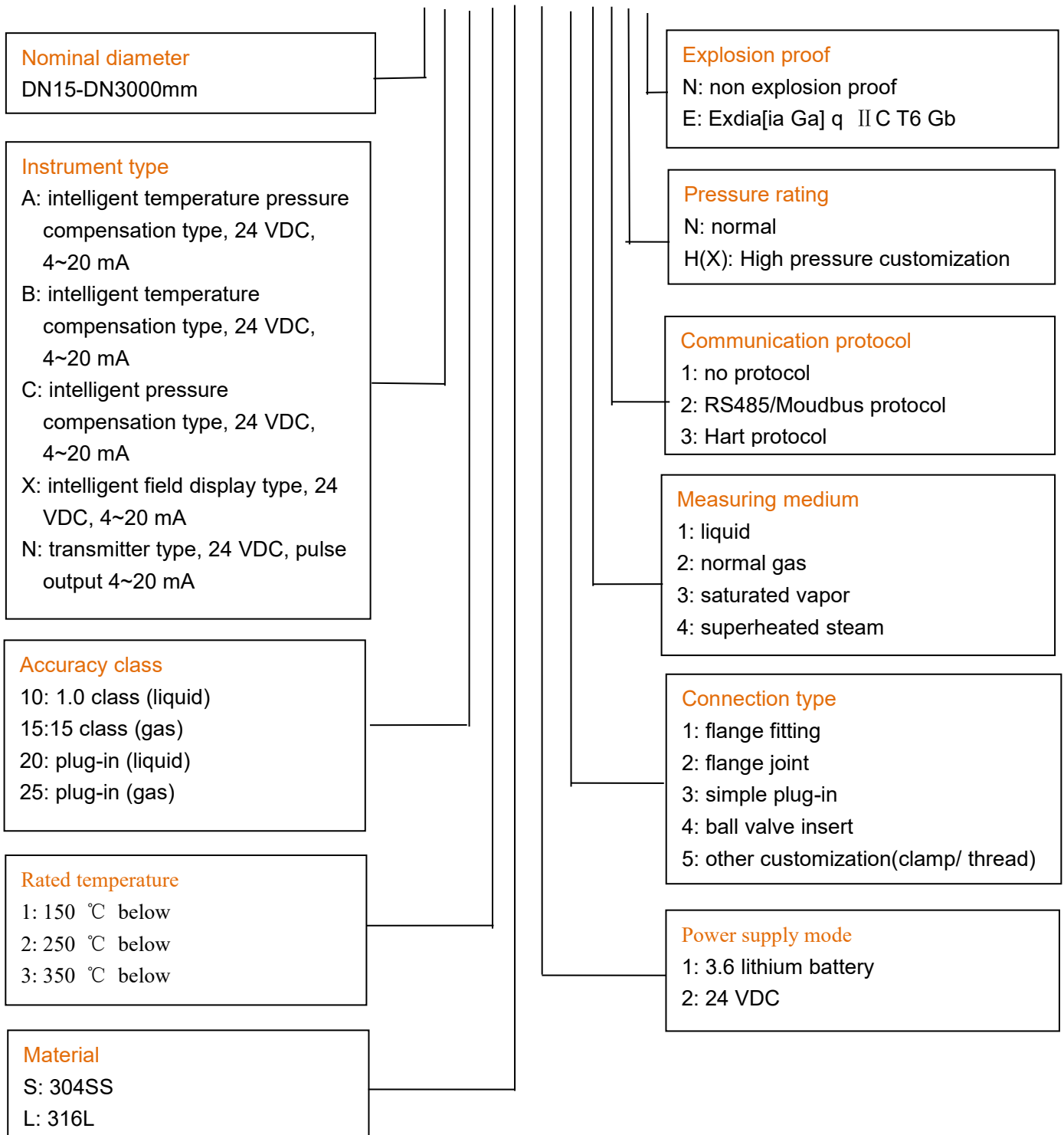

Wotian reserves the right to make any change in this publication without notice. The information provided is believed to be accurate and reliable as of this product sheet.



Cotact us

Nanjing Wotian Technology Co.,Ltd.

Website: www.wtsensor.com

Add: 5 Wenying Road, Binjiang Development Zone, Nanjing, 211161, China

E-mail: dr@wtsensor.com